

An aerial night photograph of Santa Clara, California. The city is illuminated with lights, and the mountains in the background are visible under a dark sky. In the center-right, the Santa Clara University stadium is brightly lit, showing its distinctive red and white architecture. To the left of the stadium, there are several modern, multi-story buildings with glass facades, some of which are also lit up. A river or canal winds through the lower part of the image, surrounded by greenery and trees. The overall scene conveys a sense of urban development and progress.

DISCOVER  
**SANTA  
CLARA**®

Think big.  
Look forward.



# In the heart of Silicon Valley.

Uncover the perfect combination of innovation, small-town charm and world-class amenities in Santa Clara. Here, you can experience the best of everything.

In the heart of Santa Clara lies a dynamic force that has propelled the high-tech industry to unprecedented heights. Beyond the revolutionary innovations, there lies a soulful spirit and community for those who dare to dream.

- Santa Clara is meticulously tended to with an inviting atmosphere and a mere 6-miles from the bustling energy of the San Jose International Airport. Not to mention that the city boasts 300 days of sunshine a year, but who's counting?
- Step into a world of possibilities at our Convention Center, where 302,000 square feet of exceptional space awaits, accompanied by the added benefit of plentiful complimentary parking.
- Stay awhile and immerse yourself in the atmosphere, savoring the experience as you unwind in one of our hotel's chic guestrooms.
- Santa Clara serves as the gateway to the renowned Napa and Livermore Valley wine regions, San Francisco, and the stunning beauty of our West Coast beaches.

Our cultural diversity, emerging food scene, and world-class entertainment options are just a few things that make Santa Clara an unparalleled destination for your next event.



## Play



## Attractions

### LEVI'S® STADIUM

Levi's® Stadium is one of the premier sports and entertainment venues in the world and is home of the San Francisco 49ers. Levi's® Stadium hosted Super Bowl 50 in 2016 and has been selected to host Super Bowl 60 and key games of FIFA World Cup in 2026.

### CALIFORNIA'S GREAT AMERICA

This amusement park features more than 60 rides, thrilling roller coasters, kid-sized fun in Planet Snoopy, and South Bay Shores waterpark.

### TOP GOLF

A sports entertainment complex that features an inclusive, high-tech golf game that everyone can enjoy, paired with an outstanding food and beverage menu, climate-controlled hitting bays and music.

### K1 SPEED

Ride an all-electric go kart at the world's premier indoor go kart racing operator since 2003.

### WINCHESTER MYSTERY HOUSE

Experience the architectural marvel steeped in myth and legend, built by the Winchester heiress. The mansion is California Historical Landmark No. 868.

### MISSION SANTA CLARA DE ASIS

The 8<sup>th</sup> of 21 missions built in California by the Spanish Franciscans. Founded in 1777, this mission is California Historical Landmark No. 338.



Points of interest abound in Santa Clara. Here you can take a trip to the future or go back in time – all in one afternoon.

Learn how computer chips are made at the Intel Museum – the only museum operated by a Silicon Valley firm. Play at California's Great America theme park, explore Santa Clara's early Spanish history at Mission Santa Clara de Asis or attend an event at Levi's® Stadium.

## Museums

### 49ERS MUSEUM

Featuring 11 unique gallery and exhibit spaces, the 49ers Museum is a 20,000 square foot facility dedicated to the 49ers past, present and future.

### INTEL MUSEUM

See what it's like inside an ultra-clean, highly automated silicon chip factory, and connect with technologies that give us new ways to work, learn, play, and communicate.

### COMPUTER HISTORY MUSEUM

See over 1,100 historic artifacts, including some of the first computers from the 1940's and 1950's.

### THE TECH INTERACTIVE

Committed to inspiring the innovator in everyone! Come experience a collection of hands-on exhibits, IMAX films, and more!

### THE TRITON MUSEUM OF ART

Exhibitions featuring contemporary and historical works, with an emphasis on artists of the Greater Bay Area.

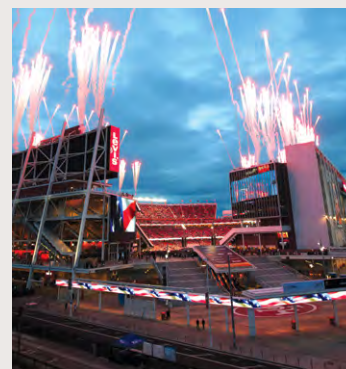

## Shop & Dine

Santa Clara is home to a variety of enclosed and outdoor shopping and dining destinations. Complete with elegant boutiques, cinemas, high end restaurants and personal care services. Don't miss your chance to shop and dine in the heart of Silicon Valley.

- Westfield Valley Fair
- Santana Row
- Santa Clara Square Marketplace
- Rivermark Plaza
- Mercado Santa Clara





# Stay



	Hotel	Address	Total Guest Rooms	Total Event Space
01	AC Hotel Santa Clara	2970 Lakeside Dr., Santa Clara, CA, 95054	185	1,389 SQ FT
02	Avatar Hotel	4200 Great America Parkway, Santa Clara, CA, 95054	168	2,924 SQ FT
03	Delta Hotel by Marriott – Santa Clara Silicon Valley	2151 Laurelwood Road, Santa Clara, CA, 95054	263	6,750 SQ FT
04	Element Santa Clara	1950 Wyatt Drive, Santa Clara, CA, 95054	175	1,415 SQ FT
05	Embassy Suites Santa Clara – Silicon Valley	2885 Lakeside Drive, Santa Clara, CA, 95054	258	4,044 SQ FT
06	Hilton Santa Clara	4949 Great America Parkway, Santa Clara, CA, 95054	280	5,142 SQ FT
07	Hyatt House Santa Clara	3915 Rivermark Plaza, Santa Clara, CA, 95054	150	500 SQ FT
08	Hyatt Regency	5101 Great America Parkway, Santa Clara, CA, 95054	505	60,000 SQ FT
09	Santa Clara Marriott	2700 Mission College Blvd, Santa Clara, CA, 95054	759	26,849 SQ FT
10	Hyatt Centric Silicon Valley	3100 Lakeside Drive, Santa Clara, CA, 95054	219	6,982 SQ FT
11	Towneplace by Marriott	2877 Lakeside Drive, Santa Clara, CA, 95054	107	
			3,069	



Discover the Santa Clara Convention Center, strategically positioned for your convenience:

- **3,069** hotel guest rooms within 5 miles
- **785** hotel guest rooms within walking distance
- **6.2 Miles** from San Jose Mineta International Airport
- **Steps** from VTA Light Rail
- **Half of a mile** from Amtrak and ACE Train Station

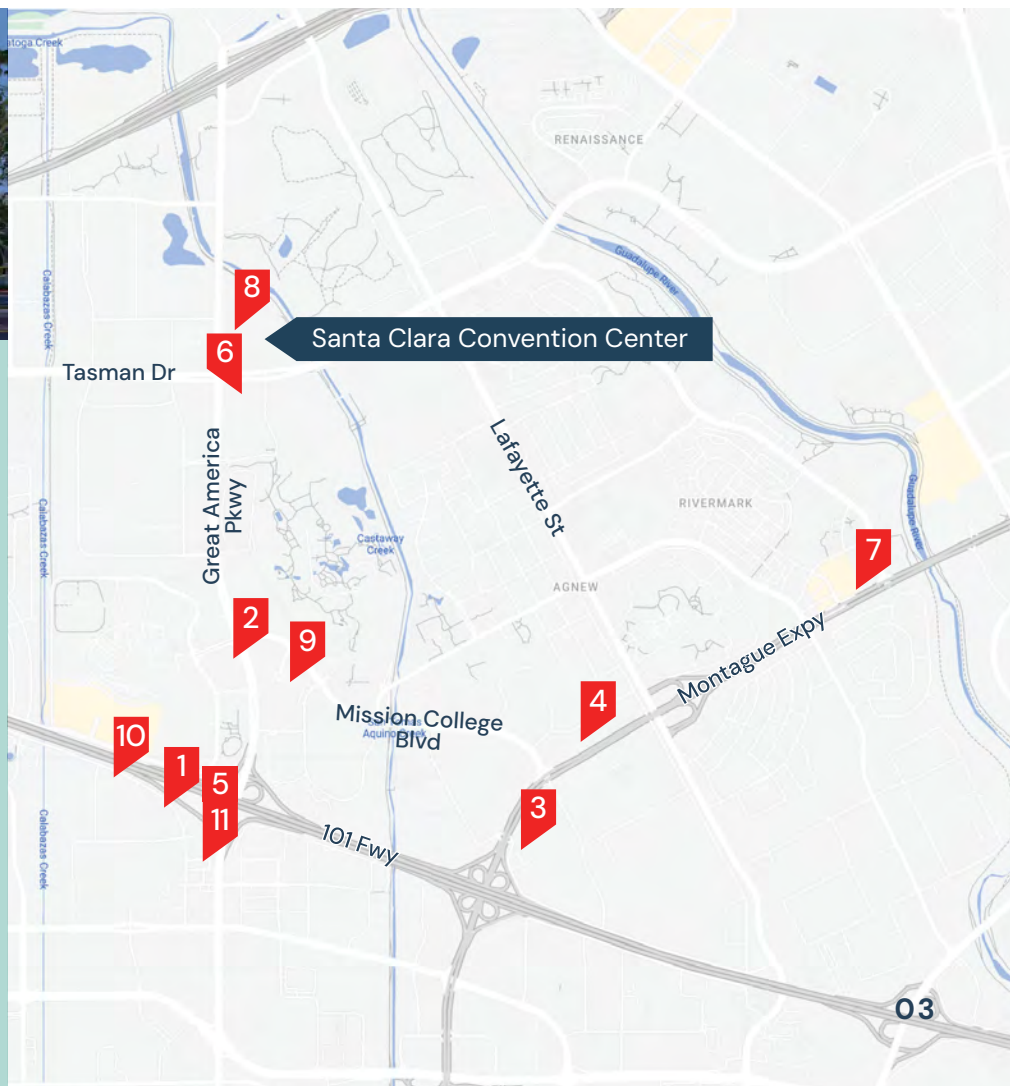

## Eat



### EATALY

Part restaurant, part specialty grocery and part experiential event destination. No matter how you choose to enjoy Eataly, fine wines, hand made pasta, prime cuts of meat and artisan cheeses await you.

### PUESTO

Puesto is an award-winning Mexican artisan kitchen & bar, owned and operated by a Mexican American family. Come enjoy handmade blue corn tortillas, a creative selection of margaritas and an industrial chic interior infused with art.

### BIRK'S RESTAURANT

This Santa Clara classic serves outstanding hardwood grilled steaks, chops and seafood.

### JANG SU JANG

This authentic Korean restaurant has earned multiple Michelin Guide recommendations for its smoky barbecue and tofu stews.

### DIN TAI FUNG

The only Northern California branch of the Taipei dumpling house that has earned a global following for its dim sum delicacies.



## Onsite Catering



### LEVY RESTAURANTS AT THE SANTA CLARA CONVENTION CENTER

Before Santa Clara gained recognition for its technological advancements, it was celebrated for its wine and architectural heritage. This means that the freshest foods and most vibrant flavor experiences are more accessible than ever. Our customizable, restaurant quality food and beverage options offer something for everyone.

### LETS TALK ABOUT...

- Custom tailored menus
- Out-of-the-box ideas
- Creative table setups
- Ferla bike cafes
- High tech Connect Cafes

We aim to support local farmers by acquiring seasonal and locally grown products. Through the practice of using sustainable farm fresh resources, our chefs start with the freshest ingredients. Crafting menus as vibrant and creative as our community. We believe the dining experience should be as unique as the city itself. Everything is tailored to the guest, we customize every detail to the imaginative preferences of our guests.



## Unique Venues



### LEVI'S® STADIUM:

Levi's® Stadium, the home of the San Francisco 49ers, is our superstar neighbor.

- 68,000 seat stadium
- 400,000 square feet of event space
- Accommodates groups of 20 – 25,000
- Food, beverage and audiovisual services onsite



### THE TRITON MUSEUM OF ART

- 450 capacity
- 10,000 square feet of art gallery event space
- Beautifully manicured grounds for outdoor events

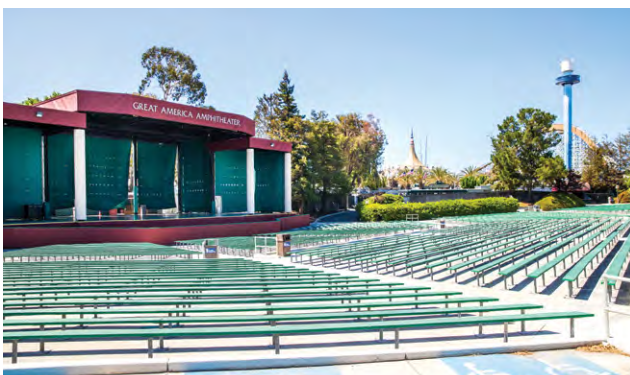

### CALIFORNIA'S GREAT AMERICA

- Private entrance available for some events
- 17,000 square feet of column free event space
- Indoor and outdoor facilities
- Food, beverage and audiovisual services onsite

# Santa Clara Convention Center



The 302,000 sq. ft. complex features 31 breakout rooms, three ballrooms, 90,000 sq. ft. column free exhibit hall, 607-seat theatre and more.

The center can be used in multiple configurations for a variety of meetings or events. The Convention Center is surrounded by over 3,000 hotel rooms and is just steps from California's Great America theme park and Levi's® Stadium. The Convention Center also has experienced, reliable in-house service providers, including full service caterer Levy Restaurants, audiovisual services by Encore Media and internet services by Smart City Networks.

## EXHIBIT HALL

- 90,000 sq.ft. of column-free space
- Accommodates 489 10x10 booths

## MEETING SPACES

- 67,500 sq.ft. of meeting/banquet rooms, divisible into 31 rooms
- 607-seat theater

## FOOD SERVICE

- Personalized and customizable service
- Four concession stands in exhibit halls
- Ability to cater and serve 5,000 at a single seating

## COMPLIMENTARY PARKING

- 1,500-space attached garage
- Additional spaces available across the street in 1,810-space garage

## LOAD IN/OUT

- 12 loading docks with three direct drive-ons

## CLEARANCE

- Nine loading docks with three direct drive-ons

## ELEVATORS

- Two passenger elevators
- Freight elevator (10'x10', 10,000 lbs capacity)

## UTILITIES

- Compressed air and water
- Electrical in designated boxes every 30' ground level

## SPECIAL FEATURES

- One block to light-rail station
- Attached to a 505, first-class guest room hotel
- Six miles to Norman Y. Mineta San Jose International Airport
- Surrounded by over 3,000 guest rooms
- Private terraces, with views of the Santa Cruz Mountains, 200+ capacity
- Within walking distance to California's Great America, Levi's® Stadium

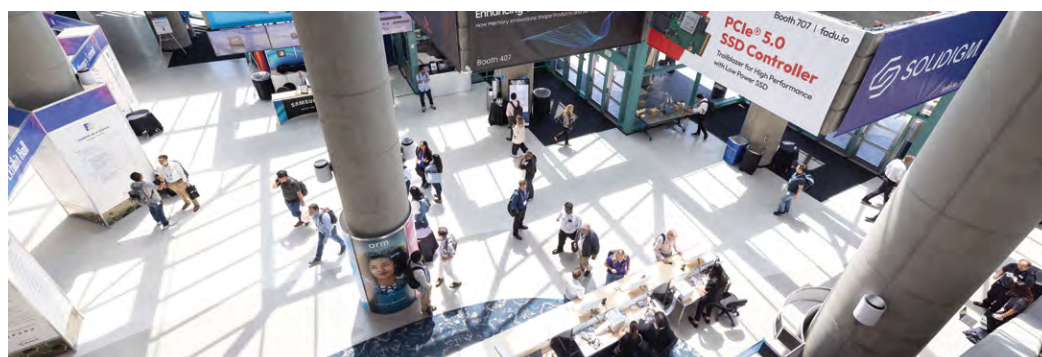

## SECOND FLOOR

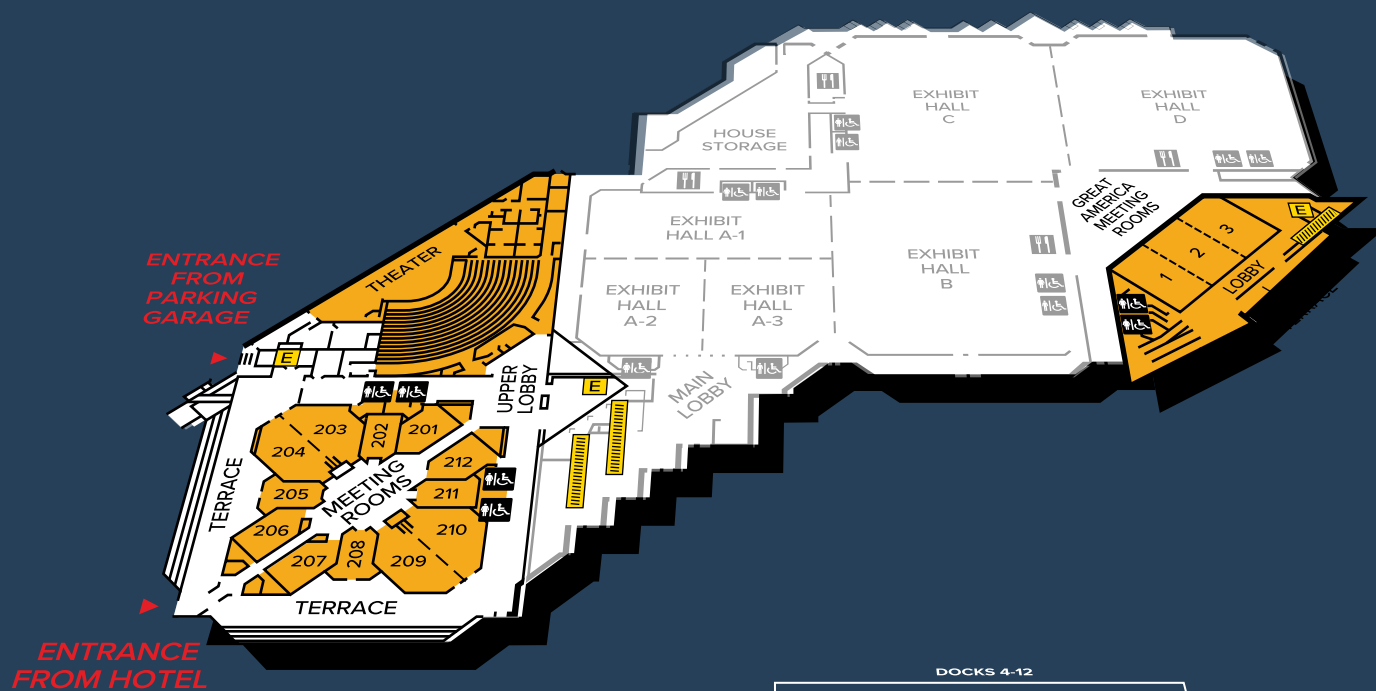

## FIRST FLOOR

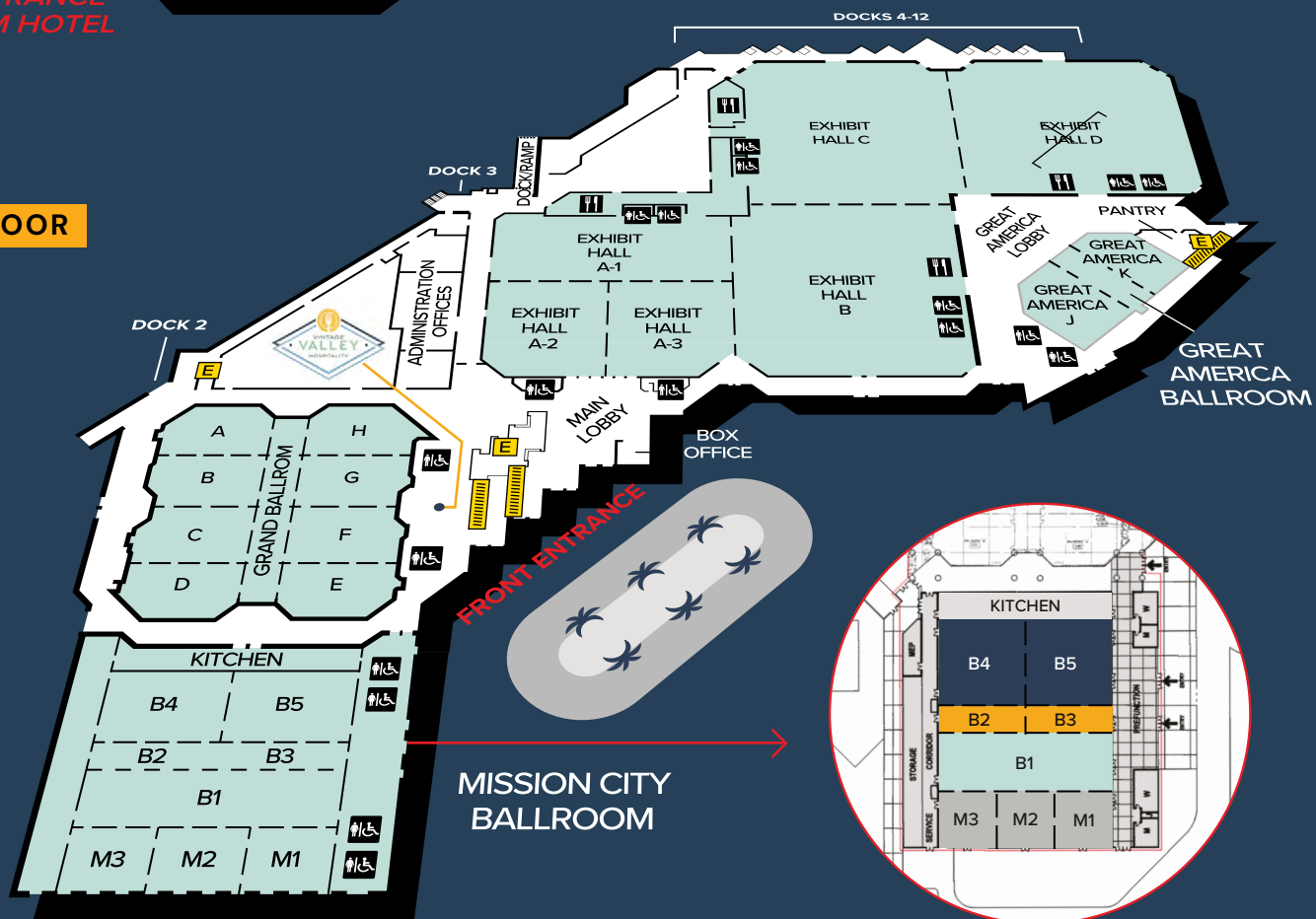

Elevator



Food & Drinks



Men's Restroom



Women's Restroom



# FIRST FLOOR

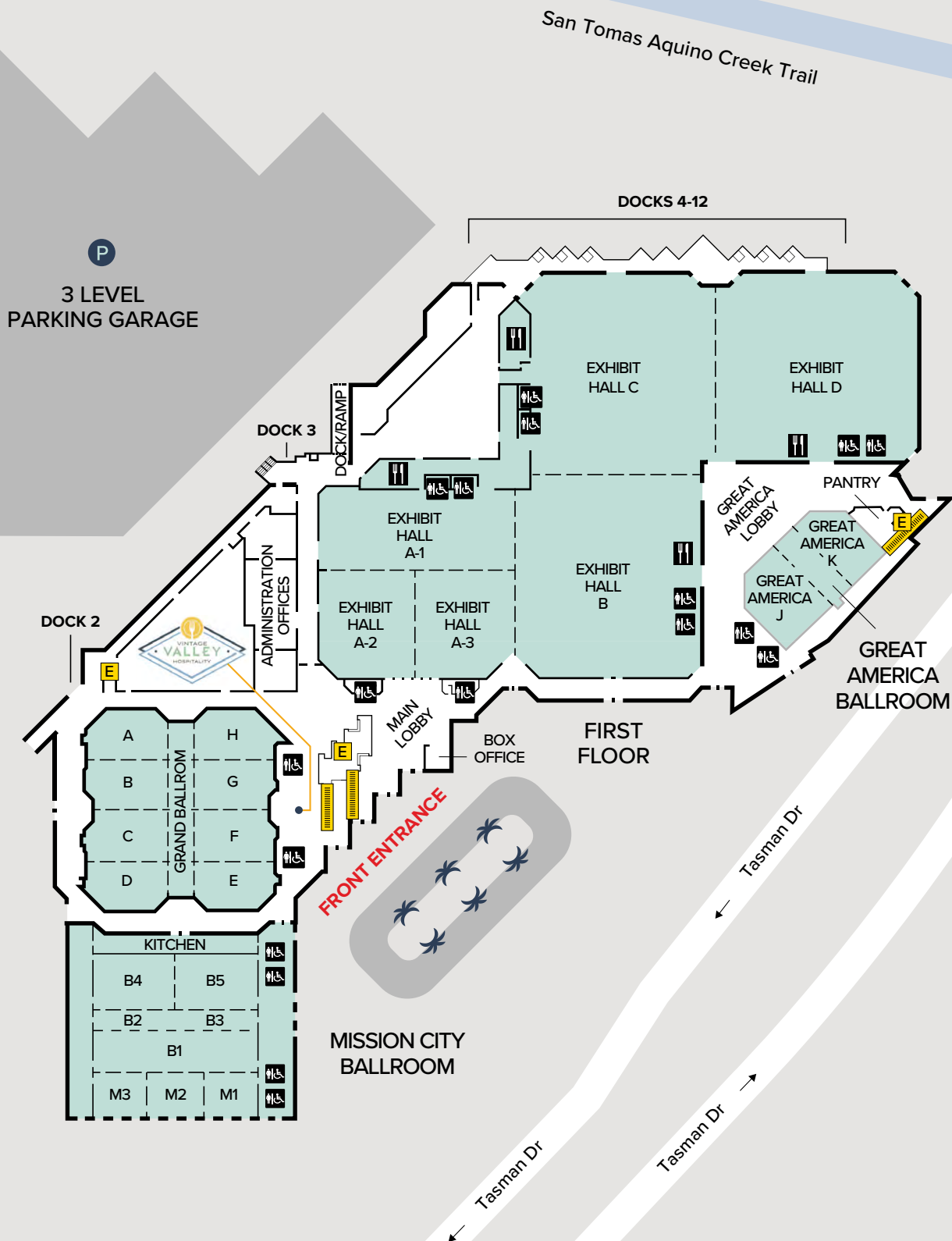





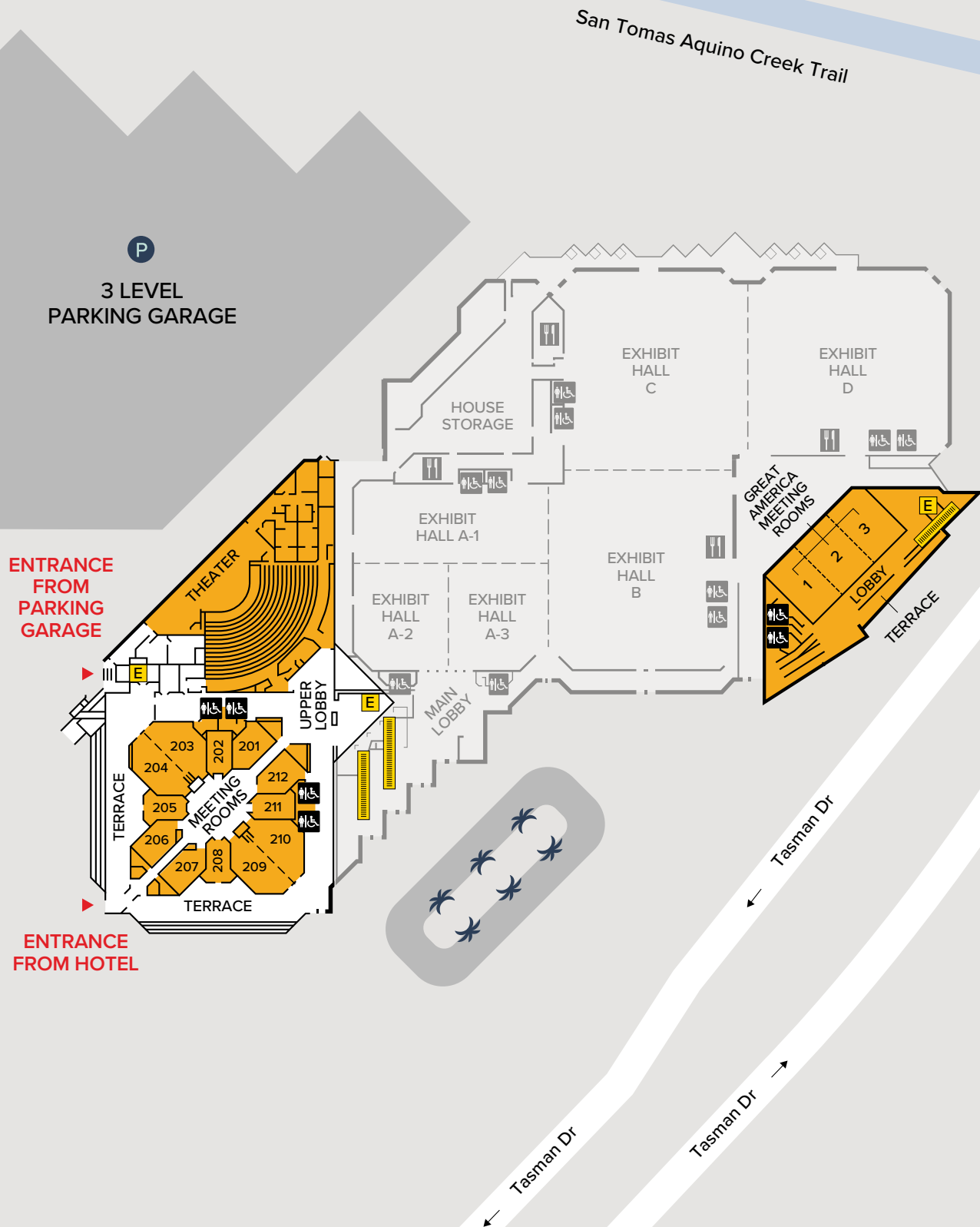

## SECOND FLOOR





## SPACE & CAPACITIES

Space	Space	Theater	Banquet	Crescent	Classroom
					
<b>Exhibit Halls A-D</b>	<b>90,014</b>				
<b>Hall A</b>	22,758	1,800	1,300	650	1284
Hall A1	10,676	900	510	255	220
Hall A2	5,834	500	300	150	110
Hall A3	6,250	500	350	175	110
<b>Hall B</b>	23,604	1,800	1,500	750	1419
Halls A & B	46,362	3,500	2,000	1,000	2724
<b>Hall C</b>	21,826	1,900	1,100	550	1493
Halls B & C	45,430	2,000	2,000	1,000	2723
Halls A, B, C	68,188	5,000	3,500	1,750	3730
<b>Hall D</b>	21,826	1,900	1,100	550	1433
Halls C, D	43,652	3,800	2,000	1,000	2636
Halls B, C, D	67,256	5,400	4,200	2,100	3730
<b>Mission City Ballroom</b>	<b>22,400</b>	<b>2,100</b>	<b>1,400</b>	<b>700</b>	<b>1,260</b>
MCBR B1	5,512	600	300	150	398
MCBR B2+4	5,774	550	350	175	312
MCBR B3+5	5,364	550	350	175	299
MCBR M1	1,890	150	90	45	96
MCBR M2	2,003	150	90	45	112
MCBR M3	1,887	150	90	45	96
(1/3) MCBR M1-3	5,780	450	300	150	336/230
(1/3) MCBR B1-3	8,285	800	500	250	369/480
(1/3) MCBR B4+5	8,321	1,000	500	250	462
(1/2) MCBR M1-3 + B1	11,300	1,250	900	450	672
(1/2) MCBR B2-5	11,098	1,100	700	350	598
(2/3) MCBR B 1-5	16,606	1,500	1,100	550	1012
<b>Great America Ballroom</b>	<b>6,264</b>	<b>640</b>	<b>430</b>	<b>215</b>	<b>354</b>
(1/2) Great America Ballroom J	3,038	300	190	80	147
(2/3) Great America Ballroom J/x	4,421	400	290	145	268
(1/3) Great America Ballroom K	1,888	175	90	45	116
(1/2) Great America Ballroom K/x	3,226	300	190	80	147
<b>Grand Ballroom (G/H only)</b>	<b>5,040</b>	<b>500</b>	<b>330</b>	<b>150</b>	<b>277</b>
Grand Ballroom G	2,560	240	75	35	140
Grand Ballroom H	2,480	240	75	35	137
<b>Meeting Rooms 201-212</b>					
201, 206, 207, 212 (ea.)	850	80	50	25	45/42
202, 205, 208, 211 (ea.)	600	30	30	15	36/30
203, 204, 209, 210 (ea.)	1,400	125	80	40	75
203/204, 209/210 (ea.)	2,750	275	180	90	180
<b>Great America Meeting Rooms 1-3</b>	<b>4,871</b>	<b>480</b>	<b>270</b>		<b>280</b>
(1/3) GAMR 1, 2, 3 (ea.)	1,610	150	60	30	98
(2/3) GAMR 1+2 or 2+3 (ea.)	3,220	300	180	90	192



# Discover Santa Clara® Services



Once your event is scheduled in Santa Clara, our team can provide a variety of services designed to facilitate the planning and execution of an effective meeting. These services include consultation, collateral materials and hotel coordination for citywide conventions.

## CONVENTION SALES

The Discover Santa Clara® team is your dedicated resource for the effortless access to information about our vibrant city. Let us streamline your journey and help plan your special events, conventions, tradeshow, meetings and conferences. Our sales team will:

- Assist with your site selection process
- Let us handle sending your RFP to our hotel partners, ensuring you receive detailed proposals with rates and availability
- Schedule hotel site inspections and tour facilities with you

## PRE-PROMOTION ATTENDANCE BUILDING

We can increase attendance for your event by showcasing it on our website and in our email newsletter.

## CONVENTION ASSISTANCE

Through a membership base of businesses throughout the community, the DMO will serve as your liaison for finding firms that have products or services to offer you and your delegates. We can also provide guidance for off-site activities that will showcase Santa Clara and enhance your meeting.

## MEDIA ASSISTANCE

If you're looking to boost attendance for your event among locals, just give us a heads-up and we'll supply you with a list of media contacts.

## CIVIC OFFICIAL LIAISON

The DMO can provide the appropriate contacts for all of Santa Clara's city and civic officials.

## POST EVENT SERVICES

Support in collecting hotel data upon the conclusion of your event.

For more information on these services please contact the DMO.

Like and Follow  
@DiscoverSantaClara



DSCAdmin@discoversantaclara.org



(408) 748-7095





## Related Santa Clara...

Transforming the way we stay, shop and dine.

Related Santa Clara is a 240-acre redevelopment that represents one of the most ambitious and transformative projects in the area's history.

This, world-class, urban environment will include 700 hotel rooms, a 35-acre public park, 200,000 square feet of food & beverage, featuring a curated collection of restaurants and cafes plus shopping, entertainment and more. Walking bridges will make Related accessible to pedestrians from the Santa Clara Convention Center.



## Getting here is easy.

Served by three major airports, Santa Clara is just six miles from Mineta San Jose International Airport (SJC), where more than 350 flights arrive and depart each day, with major carriers providing nonstop, domestic and international service.

San Francisco International Airport and Oakland International Airport are both within an hour by car.





# Real teams meet here.

**From the boardroom to the field, the fun really begins when you ditch the suits and lace up.**

Let the games decide the winners in the center of what's possible. Ready to shift from strategy to action?

---

Get in contact  
with us to find out  
how we can help.



DSCAdmin@discoversantaclara.org



(408) 748-7095



discoversantaclara.org

